

MEETING & PRIVATE DINING FACILITIES

Eight private function rooms on the Mezzanine Level • Private entry to first balcony of Performing Arts
 Separate banquet kitchen and pantries on the Mezzanine Level for exclusive service to private dining functions.

For reservations or a tour of our facilities, please call (503) 790-7126 or (503) 790-7125

~ MAXIMUM ROOM CAPACITY ~

Room	Dimensions	Ceiling Height	Square Feet	Roundtables	Reception	Conference	Classroom	Theatre
St. Johns	13 x 25	9'	325	-----	-----	14	-----	-----
Fremont	16 x 24	9'	384	30	30	18	18	30
Morrison	16 x 24	9'	384	30	30	18	18	30
Hawthorne	16 x 12	9'	192	10	10	-----	-----	-----
Sellwood	16 x 36	9'	576	40	40	24	24	50
Fremont & Morrison	16 x 48	9'	768	60	80	40	50	80
Broadway	29 x 40	11'	1,160	100	120	30	50	100
Symphony	16 x 26	11'	448	30	50	18	18	25
Broadway & Symphony	-----	11'	1,608	130	150	36	60	125
Opus	14 x 26	-----	364	20	30	20	-----	-----
Broadway/Symphony/Opus	-----	-----	1,972	150	200	-----	-----	-----

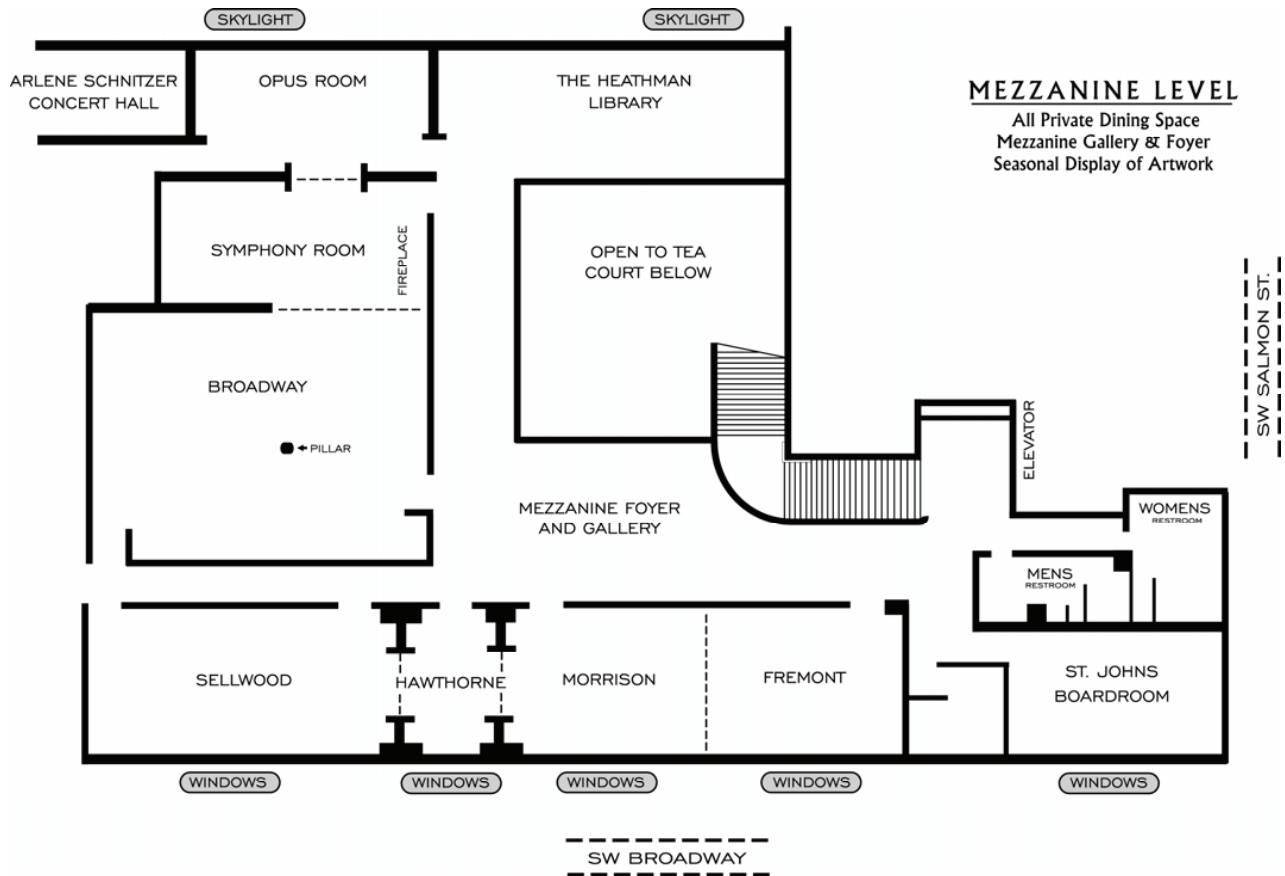



THE HEATHMAN
RESTAURANT & BAR

1001 SW Broadway • Portland, OR • 97205 • 503.790.7126 or 503.790.7125
www.heathmanrestaurantandbar.com